

The

Flat Master

Surface Sander

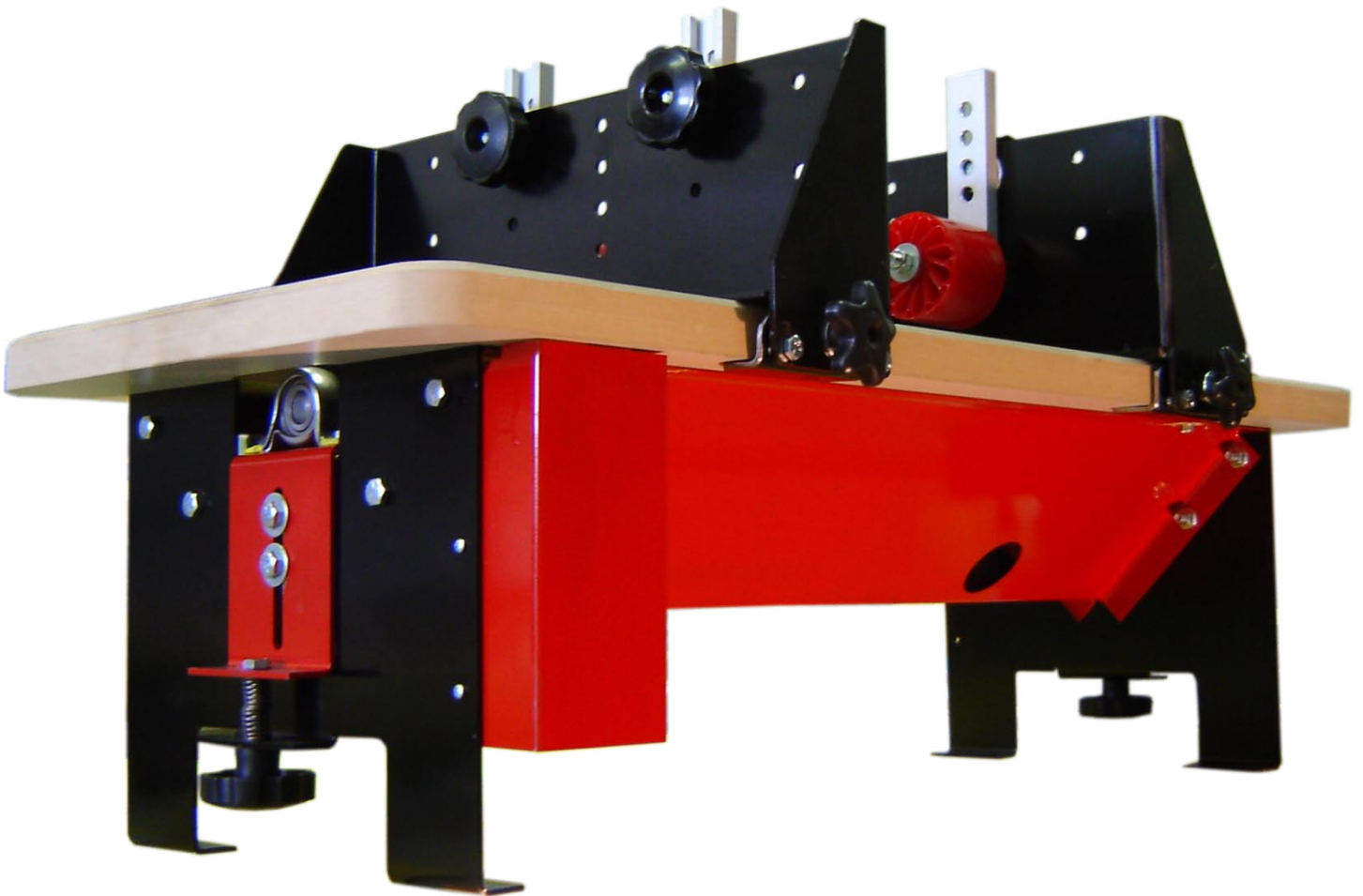

Features of the Flat Master

1. No clips needed for holding paper. VELCRO brand hook and loop is used for changing paper - simply unroll one grit and roll on another.



2. On the longer drums use two or three different grits at once.

3. Klingspor brand stearate coated paper will sand pine, paint and even nails without damaging the sandpaper, a savings to the user.

4. Sandpaper used on the Flat Master is less costly than the cloth back paper used for commercial units.

5. The drum is a polycarbonate tubing which runs cooler and eliminates static. With no static on the drum, dust won't stick to the paper. Instead it drops down into the box, allowing for easier dust collection. Just add a 4" dust collector flange to the frame and the Flat Master is virtually dust free!



6. With the use of the fences and hold downs, the sander works much like a jointer. It also works excellent with sanding longer pieces.

7. Centrifugal force is a key element. Firstly it lifts paper off the drum creating an air gap. The air gap prevents the drum from creating heat, which in turn helps paper to last longer. Secondly, centrifugal force means it takes less power to run the Flat Master as the drum is not forcing the paper into the wood.

8. Depth of cut is changed by switching the grit of sandpaper. If you want to cut more use a coarser grit, but to cut less, use a finer grit, etc.

9. The height of the drum is crucial for this sander to work properly. With the assistance of the "simple height adjustment" system, adjusting the height is now simple.

10. Moving the fences is a breeze with the new table top clamp system.

How to setup the Flat Master

1. Remove parts and Flat Master from the box and recycle the packaging according to your local regulations.
2. Place the Flat Master upside down on a bench and remove the four screws that hold the top on.
3. Place the pulley provided onto motor shaft and tighten set screw.
4. Turn the Flat Master right side up without the top attached and bolt the motor with the provided 5/16" x 1/2" bolts and nuts where the motor mount holes are cut. Note: The holes for the motor are cut according to the NEMA 48 and 56 frames. If your holes don't line up, bolt up at least one of the holes to hold the motor in place, and drill new holes to accommodate your motor.
5. Once the motor is in place, size the link belt by holding the belt around the pulley on the drum and the pulley on the motor, select the link to remove, remove the link, and then place the belt around the pulleys again and fit the links together to form a full belt.
6. Wire the motor according to the schematic on the right and place the switch anywhere on the machine as long as it is according to your local wiring codes.
7. Place the top back on the Flat Master and replace the screws to hold the top down.
8. Place a straight edge on the top across the end of the drum with the provided strip on the drum. If the drum is above the surface of the top, lower the drum by loosening the two lock bolts and turn the adjustment knob counter clockwise. If the drum is far below the straight edge, then turn the knob clockwise. Do the same for the other end of the drum. The drum has to be a paper thickness below the straight edge for proper sanding.
9. Your Flat Master is ready for use.

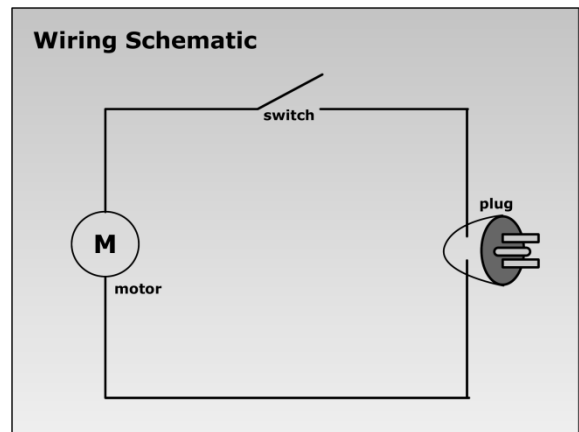

Flat Master Parts List

- 1 V-Frame
- 1 Belt Cover
- 1 Adjustment Bracket
- 1 Frame End
- 20 5/16" x 1/2" Hex Bolts
- 14 5/16" Hex Nuts
- 3" Spring(18" FM) or 2" Spring(24" & 30" FM)
- 2 5/16" x 2"(18" FM) or 3"(24" & 30" FM) Hex Bolts
- 2 #6-32 Machine Screws
- 2 #6-32 Machine Screw Nuts
- 4 5/16" Washers
- 4 #12 Top Screws
- 3' Link Belt
- 1/2" or 5/8" Bearings
- 2 3" x 5/8" Pulleys (only with 24" and 30" FM's)
- 1 2" x 1/2" Pulley (only with 18" FM's)
- 1 1.5" x 1/2" Pulley (only with 18" FM's)
- 1 MDF Top
- 1 3" x 10yd 100g Sandpaper Roll
- 1 3" x 10yd 180g Sandpaper Roll
- 1 220g Pre-Cut Sandpaper Strip
- 2 Black Plastic Knobs

Optional Parts:

- 2 Fences
- 4 Fence Clamps
- 8 1/4" x 1/2" Hex Bolts
- 6 5/16" Washers
- 4 Male Knobs
- 4 Feather Wheel Bracket Assemblies

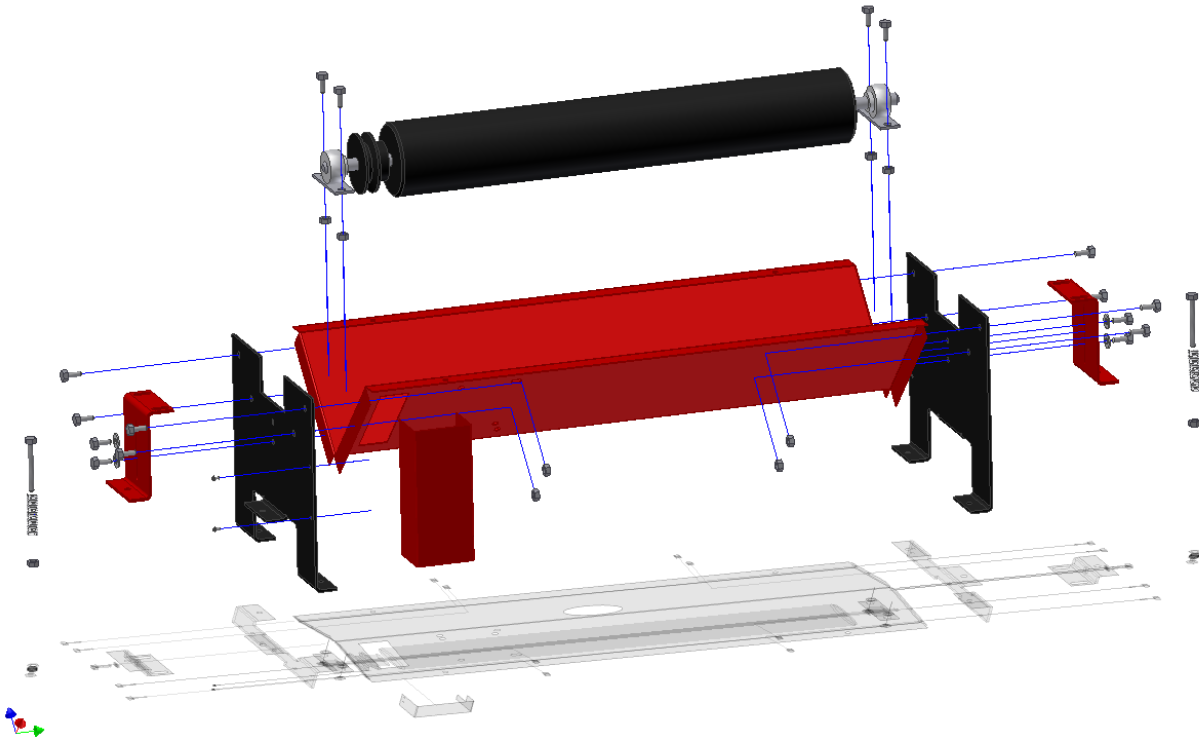

Disclaimer

Stockroom Supply is not responsible for any wiring done to the Flat Master or for any injuries due to the misuse of the Flat Master. Stockroom Supply has a limited life time warranty on the Flat Master. We will exchange or fully refund the Flat Master if we decide that the Flat Master was not abused in any way and if the problem is in the workmanship or design of the Flat Master.



Your Abrasive Specialists